

City of Yerington Nevada Title 10 Zoning Code Reference



Corner lots are required to have a 20' setback on the side and front yards. This is to allow drivers to see other cars and pedestrians on the perpendicular street.

Yard dimensions can be reduced by not more than 10% by applying for a variance with the City Planning Commission.

A fence may be up to 6' tall but cannot be more than 3' tall within 20' of the front of the parcel. For a corner lot this includes the required side yard setback.

Accessory structures (shops, sheds, etc.) must comply with setback requirements.

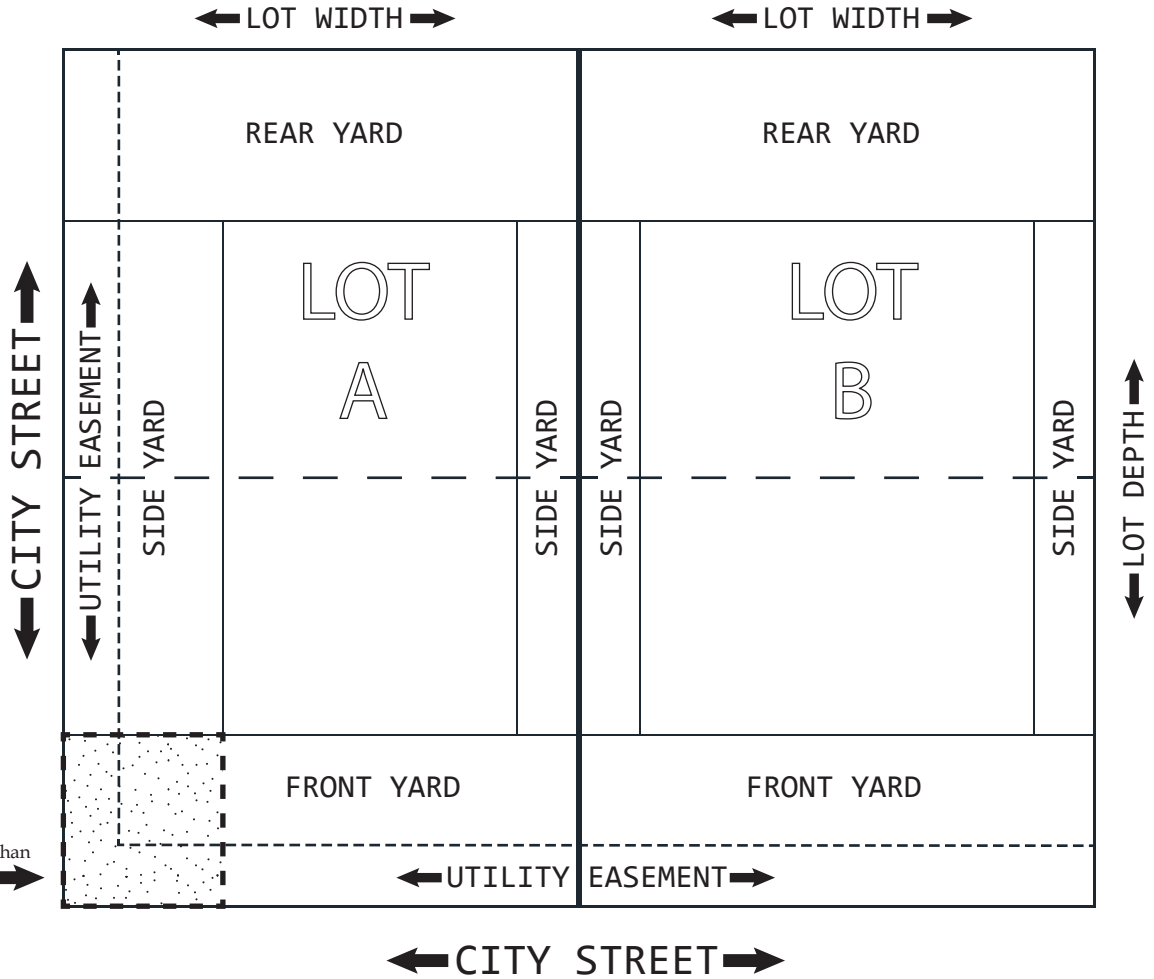

TYPE	MIN AREA (SF)	MIN AREA (AC)	MIN WIDTH (FT)	MULTI-FAMILY	FRONT YARD (FT)	SIDE YARD (FT)	REAR YARD (FT)
A	43,560	1.00	0	NO	20	7	20
C1	5,000	0.11	0	NO	0	0	20/0
C2	5,000	0.11	0	NO	0	0	20/0
HZ	5,000	0.11	0	NO	25	10	20/10
M1	5,000	0.11	0	NO	0	0	20/0
M2	21,780,000	500.00	0	NO	0	0	20/0
R1	7,000	0.16	60	NO	20	7	20
R2	7,000	0.16	60	LIMITED	20	7	20
R3	7,000	0.16	60	YES	20	7	20
RC	6,000	0.14	60	YES	20	7	20
R4	10,000	0.23	75	NO	20	10	20
R5	12,000	0.28	80	NO	20	10	20
R6	14,000	0.32	85	NO	25	10	20
R7	16,000	0.37	90	NO	25	10	20
R8	21,780	0.50	120	NO	25	10	20
R9	43,560	1.00	140	NO	25	10	20

NOTE: Should a discrepancy appear between this drawing and the Yerington City Code, the City Code always takes precedence.